

Source: Prestolite Electric Ltd - Greenford, London, UK  
Date: May 7, 2009  
Bulletin No: TSB4035 (Rev.01)  
Models: AB172RL  
Subject: Fitment of Aluminium Cast Fan to AB172RL Alternator

### Fitment support for AB172RL alternators using conversion kit 6500-385

Prestolite Despatch No's: 1282000, 1282010, 1282030M, 1282040, 1282050,  
1282060, 1282070, 1282080, 1282090, 1282100.

#### FITMENT INSTRUCTIONS

1. Remove the pulley nut, Belleville Washer, Pulley & Woodruff Key.
2. Remove the Steel Fan & 'O' Ring (important to remove the 'O' Ring) (Figure 1)

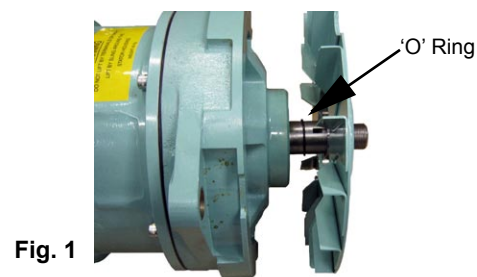

3. Fit the new 'O' Ring & the new Spacer (important to position the recess of the spacer inboard to locate the 'O' Ring) (Figure 2)

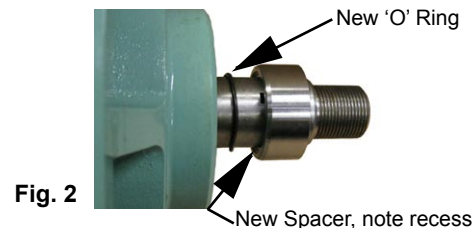

4. Fit the new Aluminium Fan. (Figure 3)



5. It is recommended to drill the two dowel holes in the pulley to fit the two spring dowels (Figure 4), the spring dowels must not protrude more than 3mm above the surface of the pulley (Figure 5).

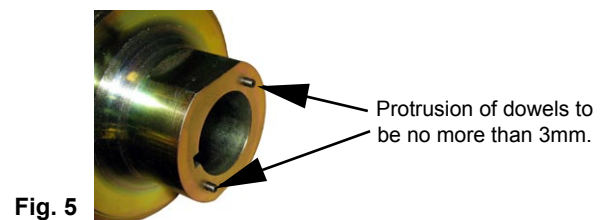
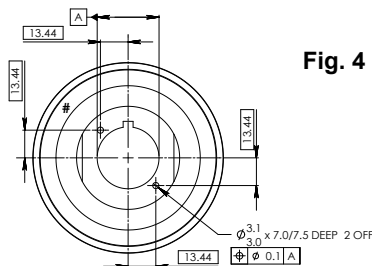

6. Fit the woodruff key, pulley, belleville washer (must be fitted correct way) & the pulley nut. Tighten to 100Nm.

**Important:** The information contained in this bulletin is intended for use by trained, professional technicians who have the proper tools, equipment, and training to perform the required maintenance described above. This information is NOT intended for 'do-it-yourselfers', and you should not assume that this information applies to your equipment. If you have any questions regarding this information please visit our website at [www.prestolite.com](http://www.prestolite.com), or contact our technical service department at: